

# ArTeN

- when it has to be right *Leica*  
Geosystems

# ArTeNDigiplanS910



## LA SOLUZIONE CREATA PER FACILITARE IL RILIEVO

# COME SETTARE LE IMPOSTAZIONI WIFI SUL DISTO

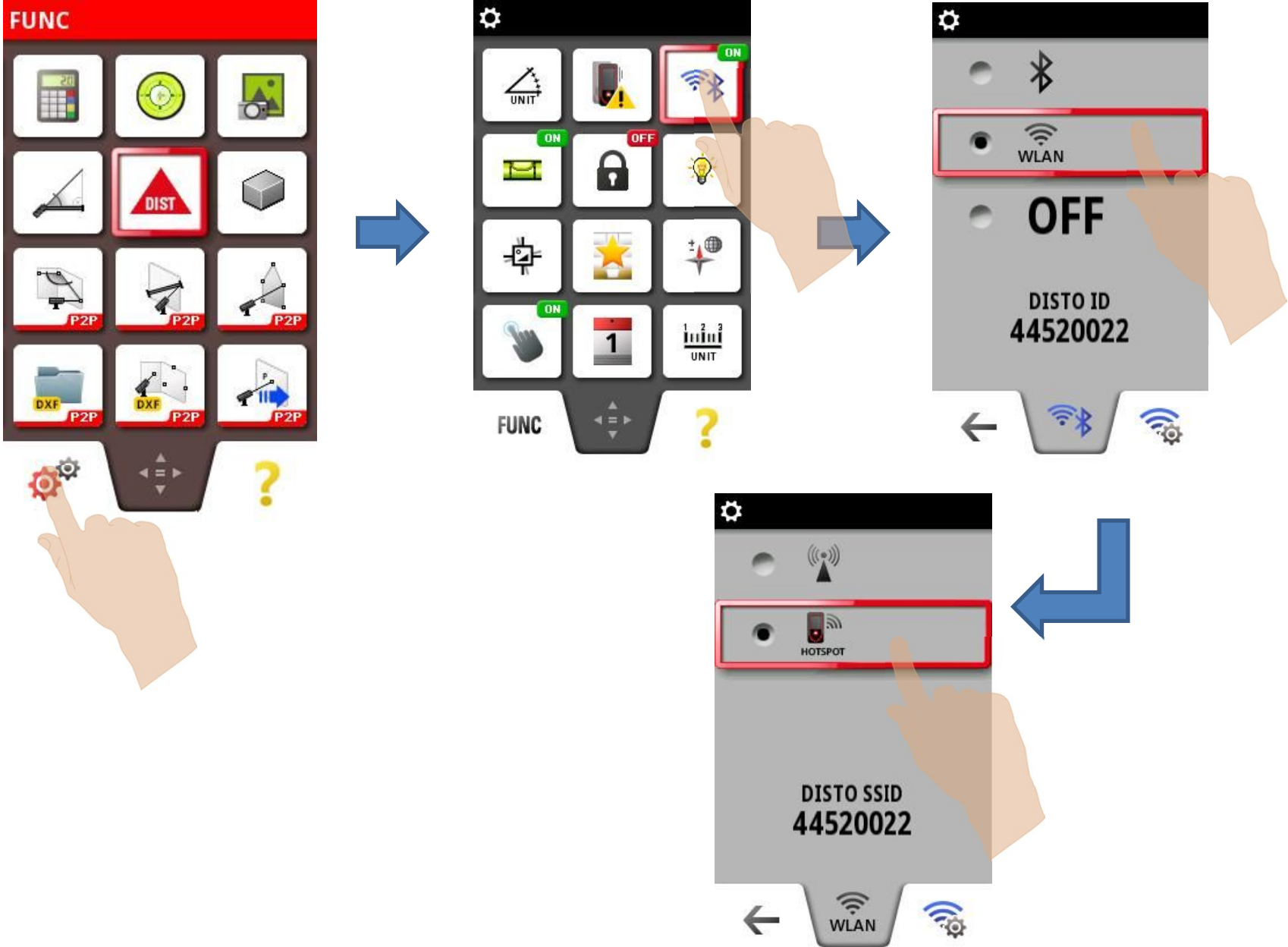

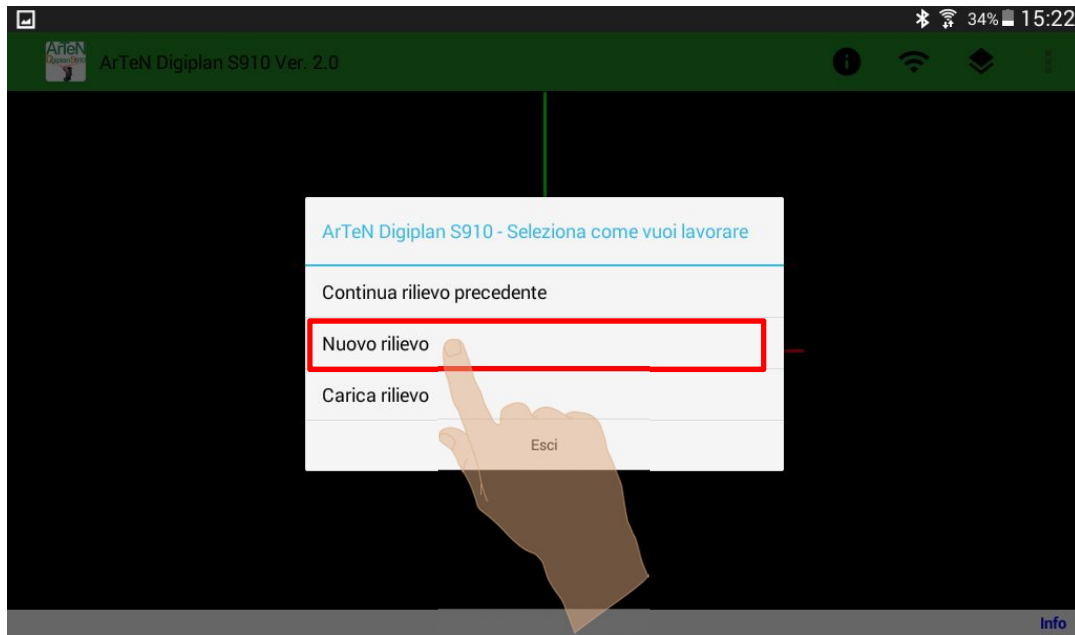

## SET NUOVO LAVORO

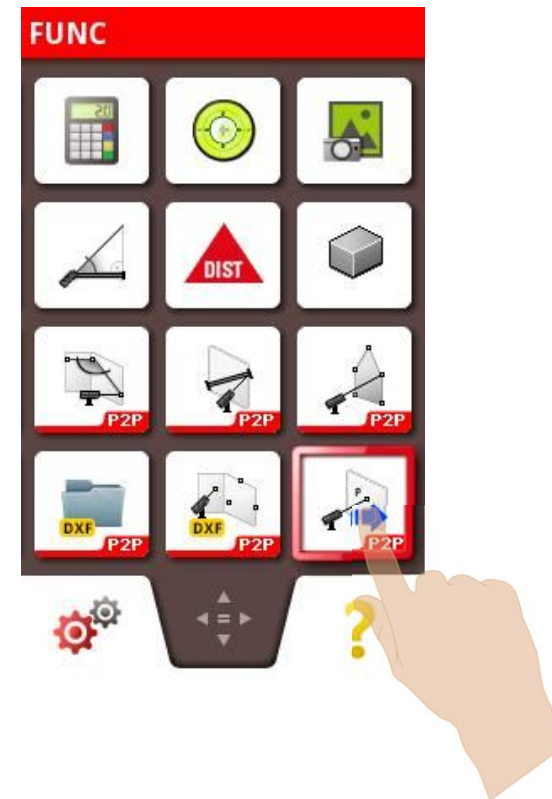

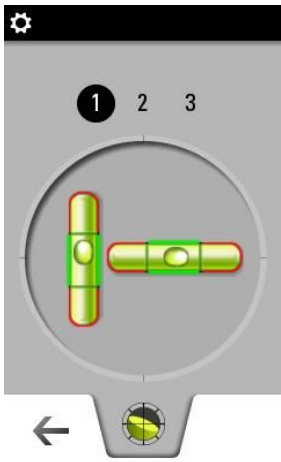

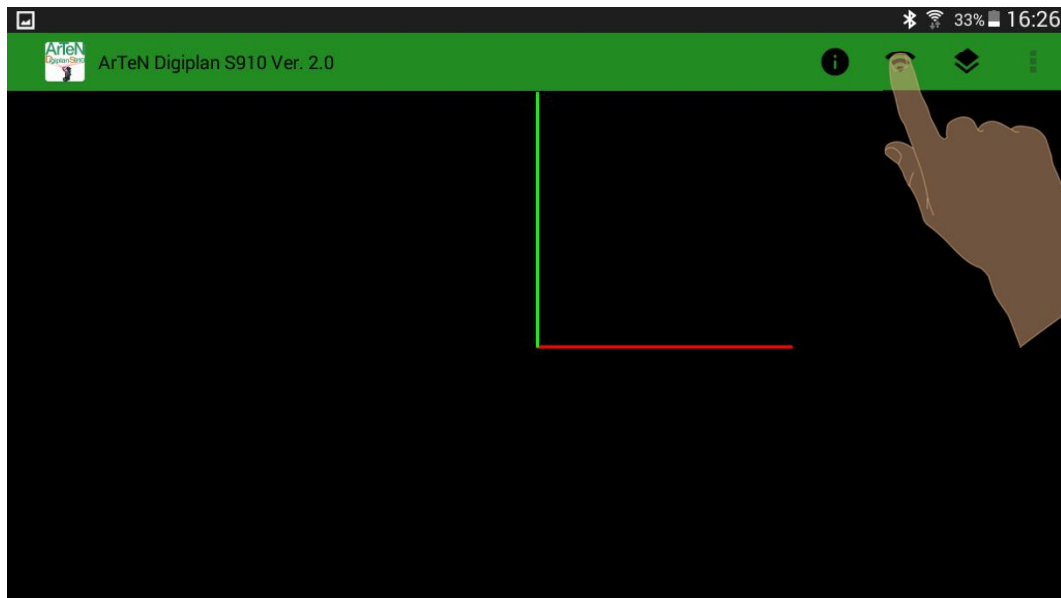

Info

## CONNESSIONE WIFI DEL DISPOSITIVO CON IL DISTO ALL'INTERNO DELL'APPLICAZIONE

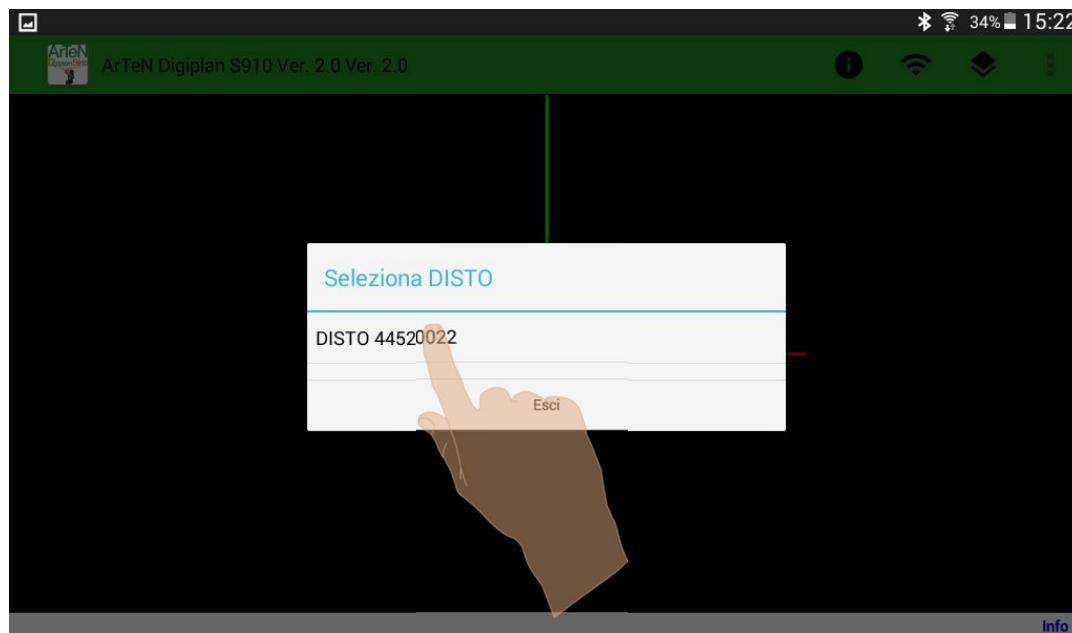

Info

**INFO LINEE E PUNTI**

**MISURA**

**MENU'**

**CONNESSIONE WIFI**

**LASER ON**

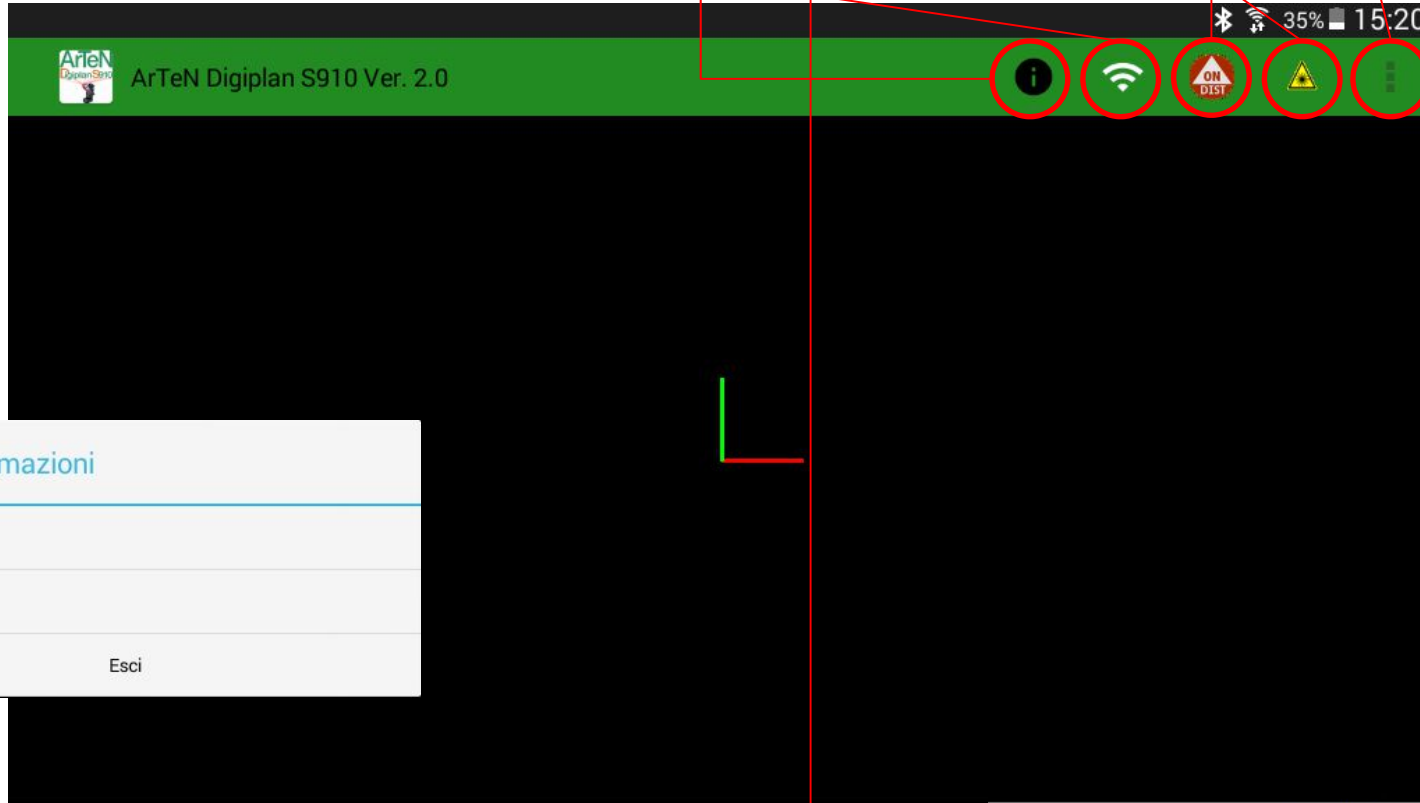

Ottieni informazioni

---

Punti

---

Linee

---

Esci

Cancella linee

**P1**



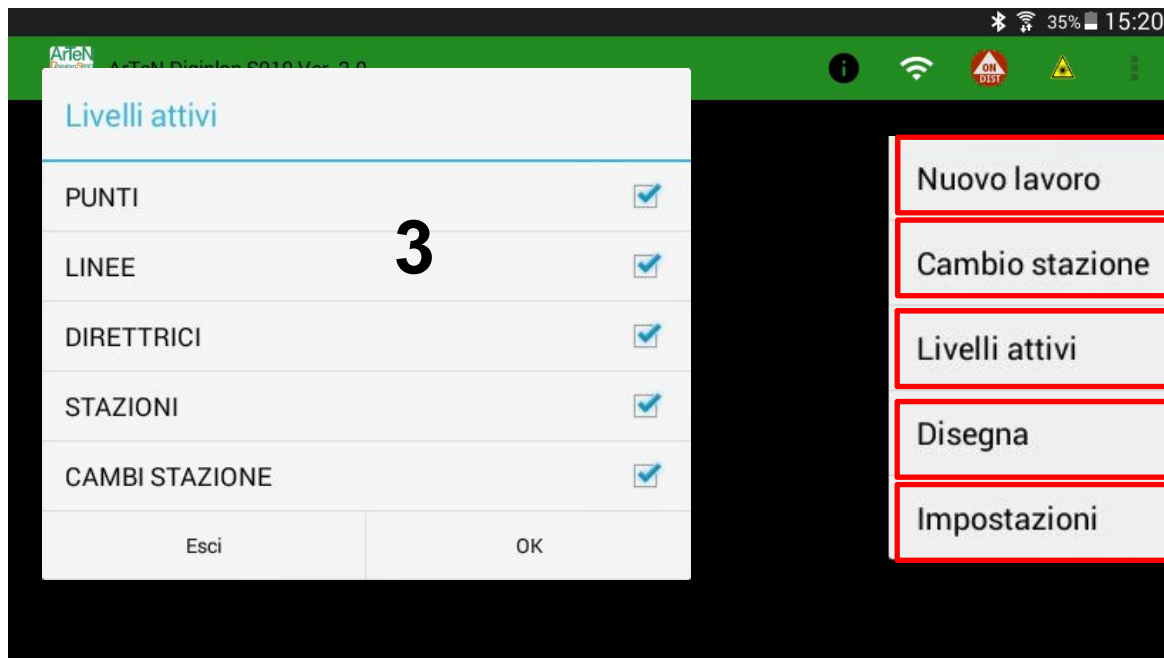

## MENU'

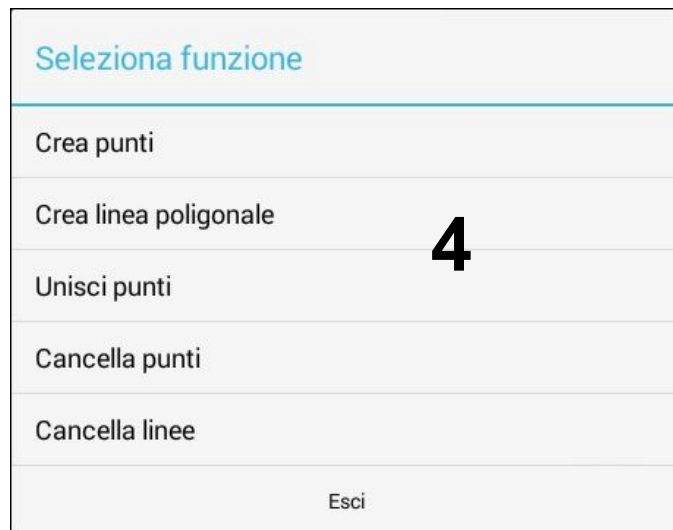

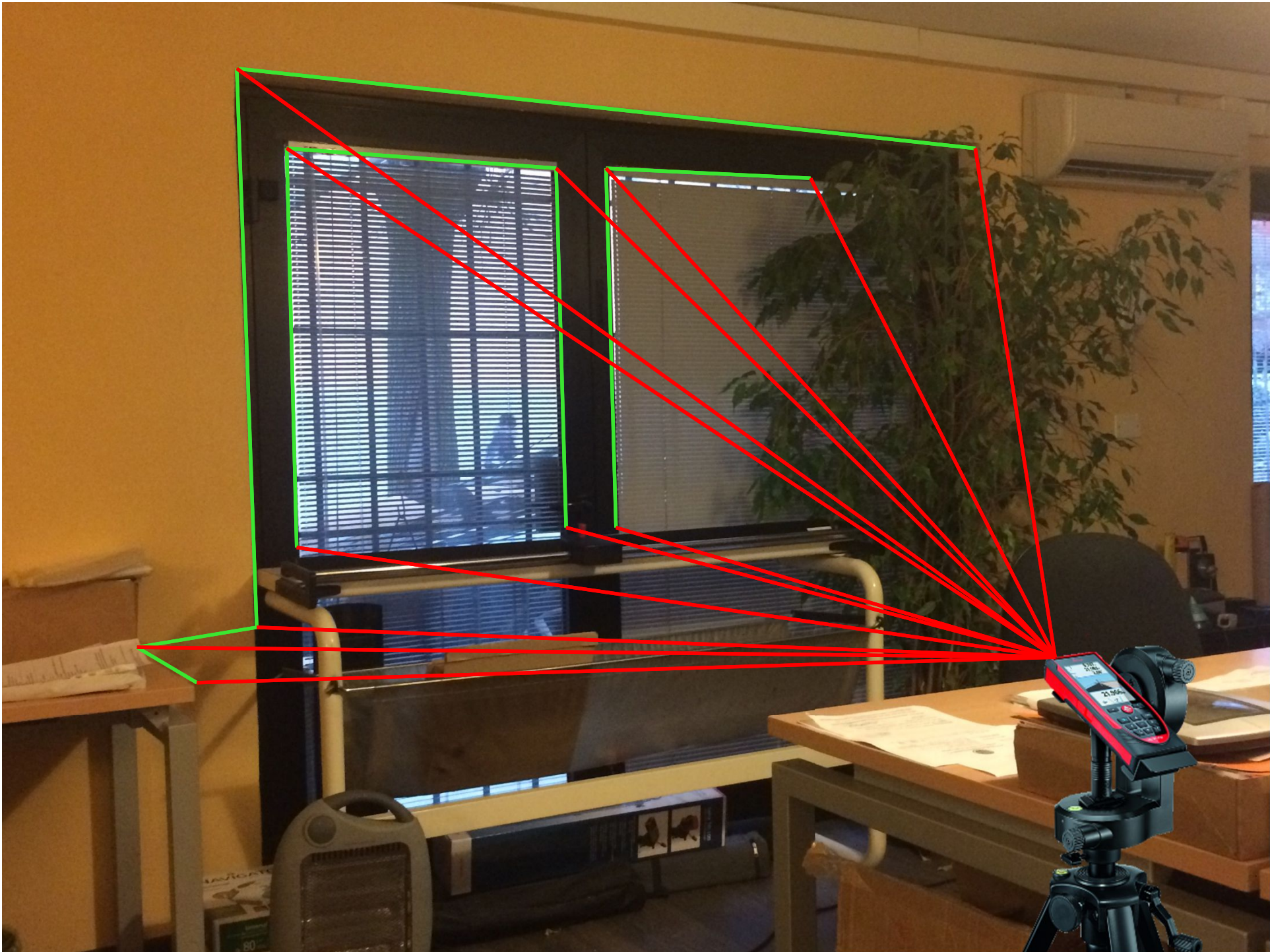

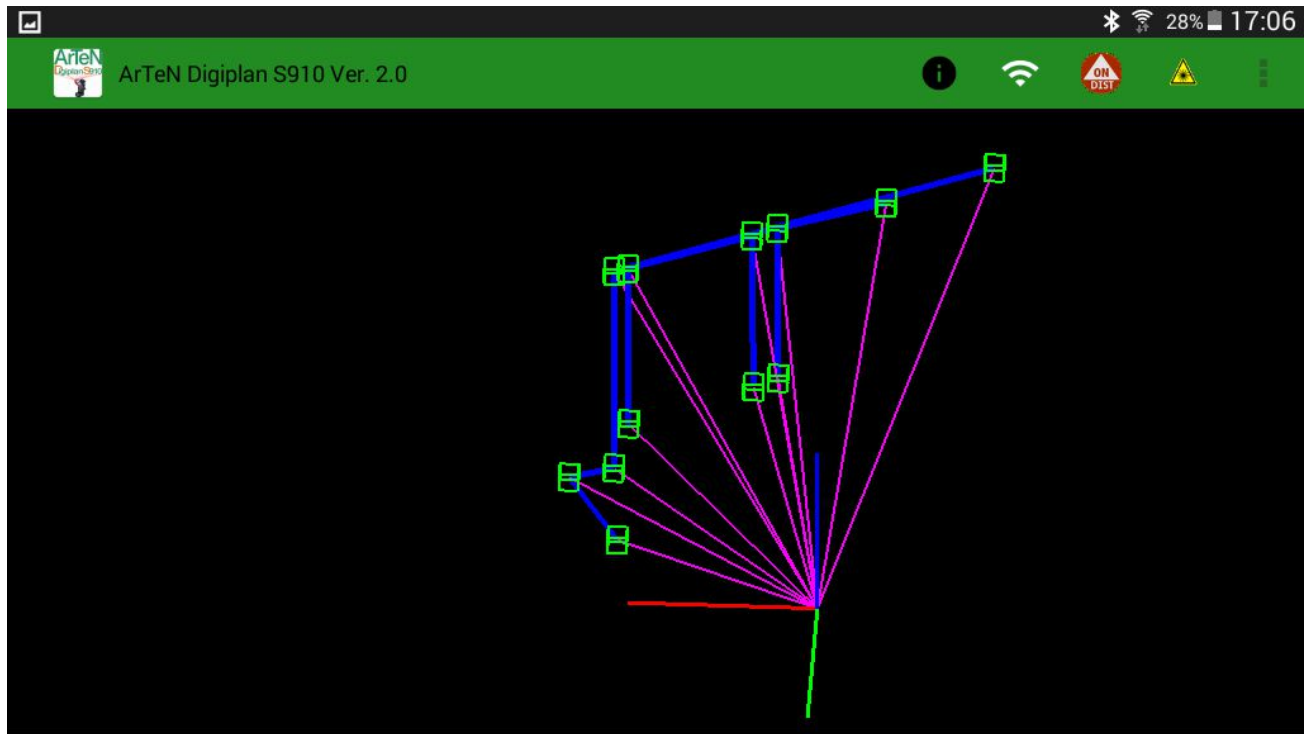

Cancella linee

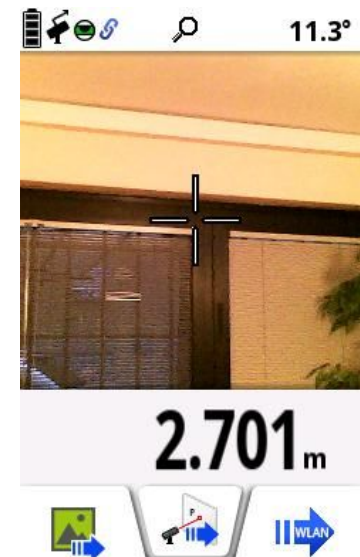
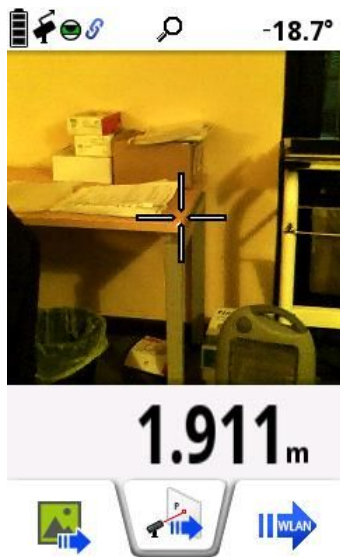

# E' POSSIBILE ATTRIBUIRE AD OGNI PUNTO RILEVATO UNA FOTO

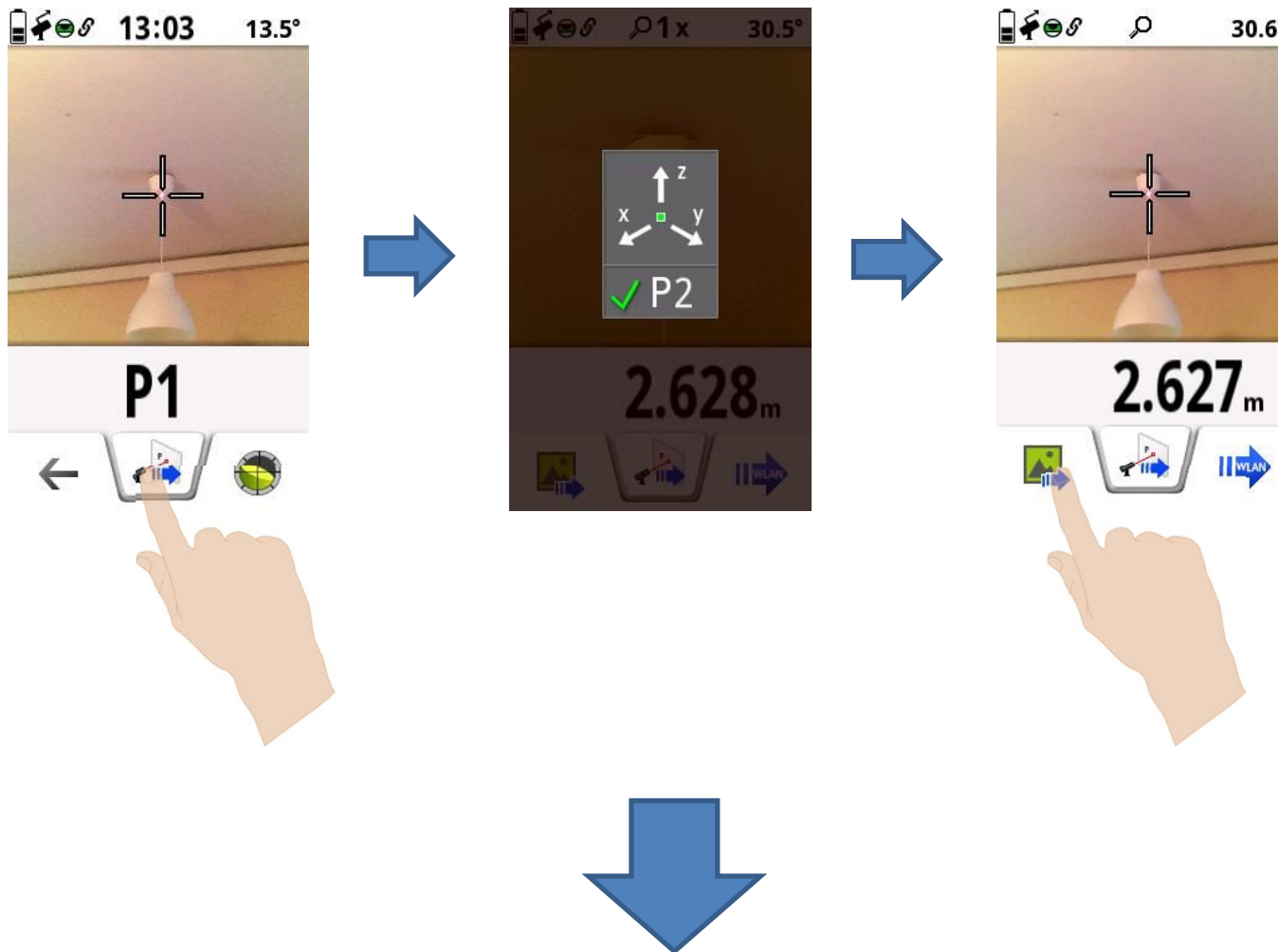



ArTeN Digiplan S910 Ver. 2.0

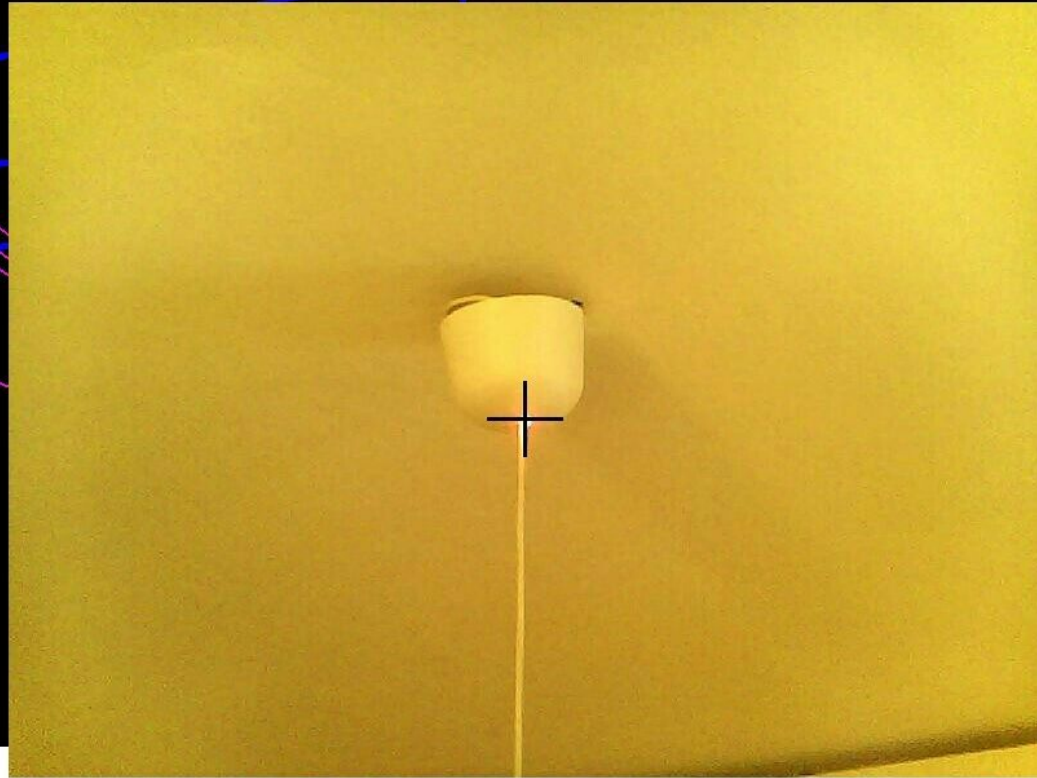
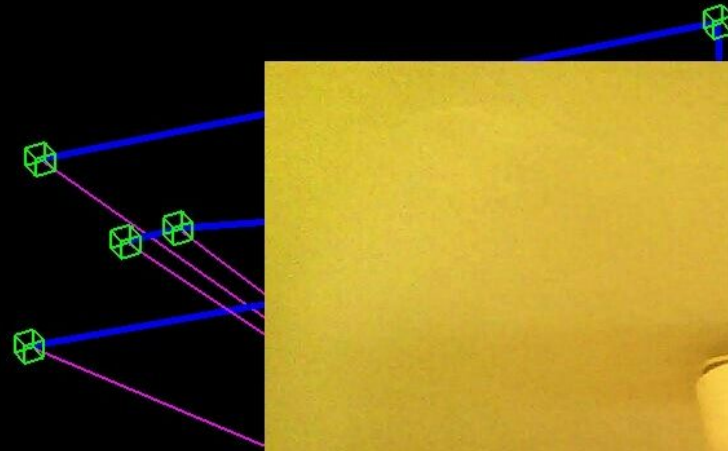

## CAMBIO STAZIONE

**DOPO AVER  
SPOSTATO  
LO STRUMENTO  
ORIENTARSI SUI  
PUNTI «NOTI» E  
SELEZIONARLI NEL  
DISPOSITIVO.  
UNA VOLTA  
SELEZIONATO IL  
TERZO PUNTO  
VIENE RICALCOLATA  
LA NUOVA POSIZIONE  
DEL DISTO**

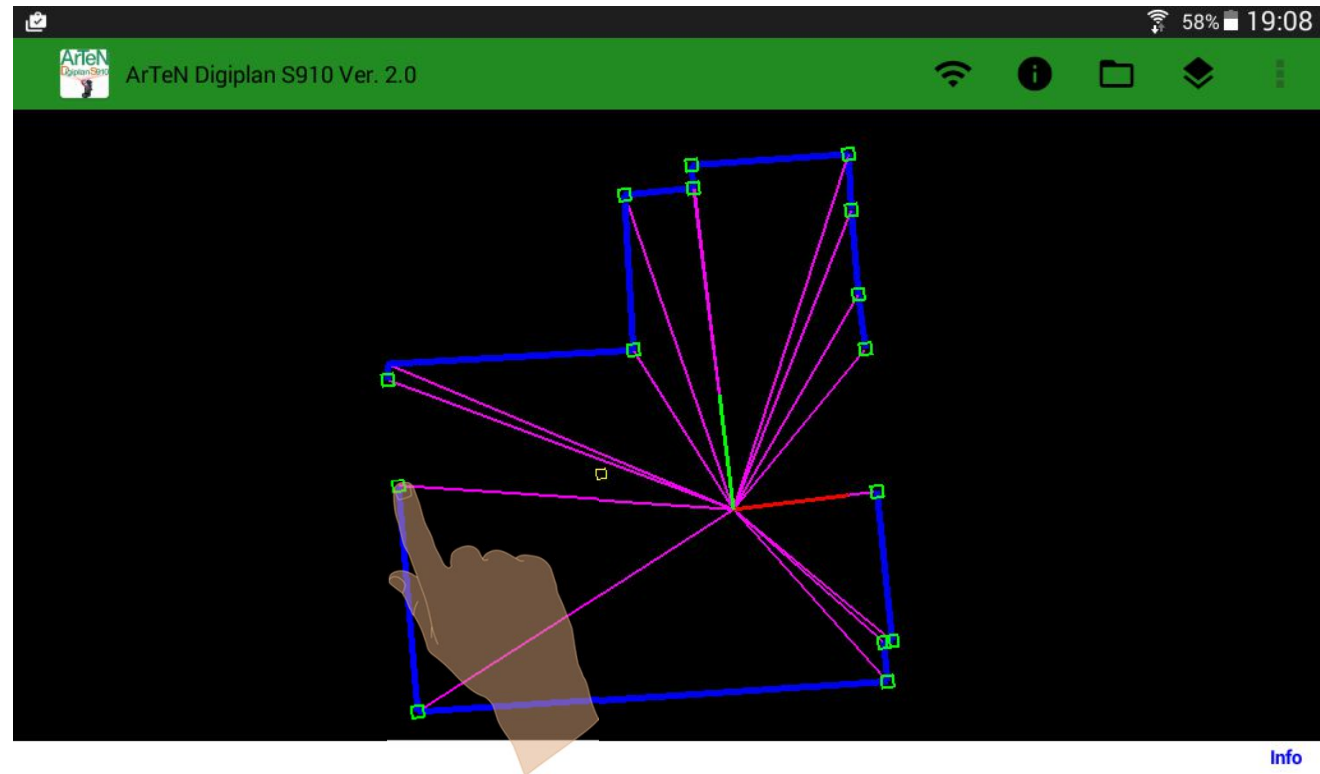

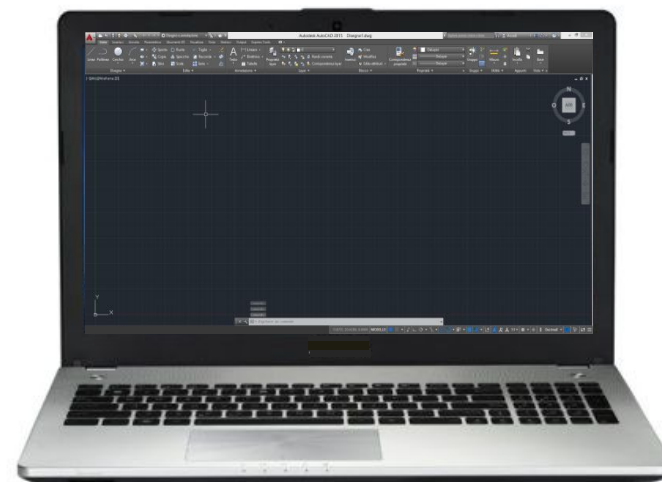
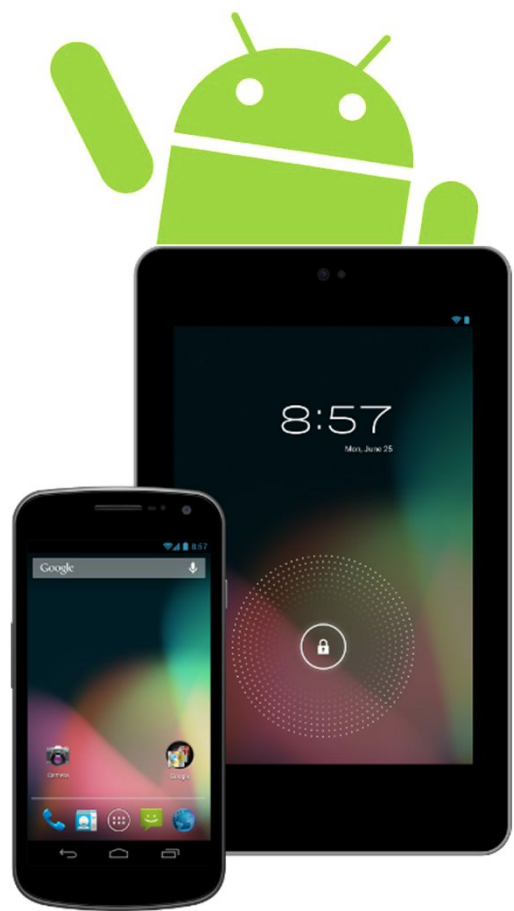

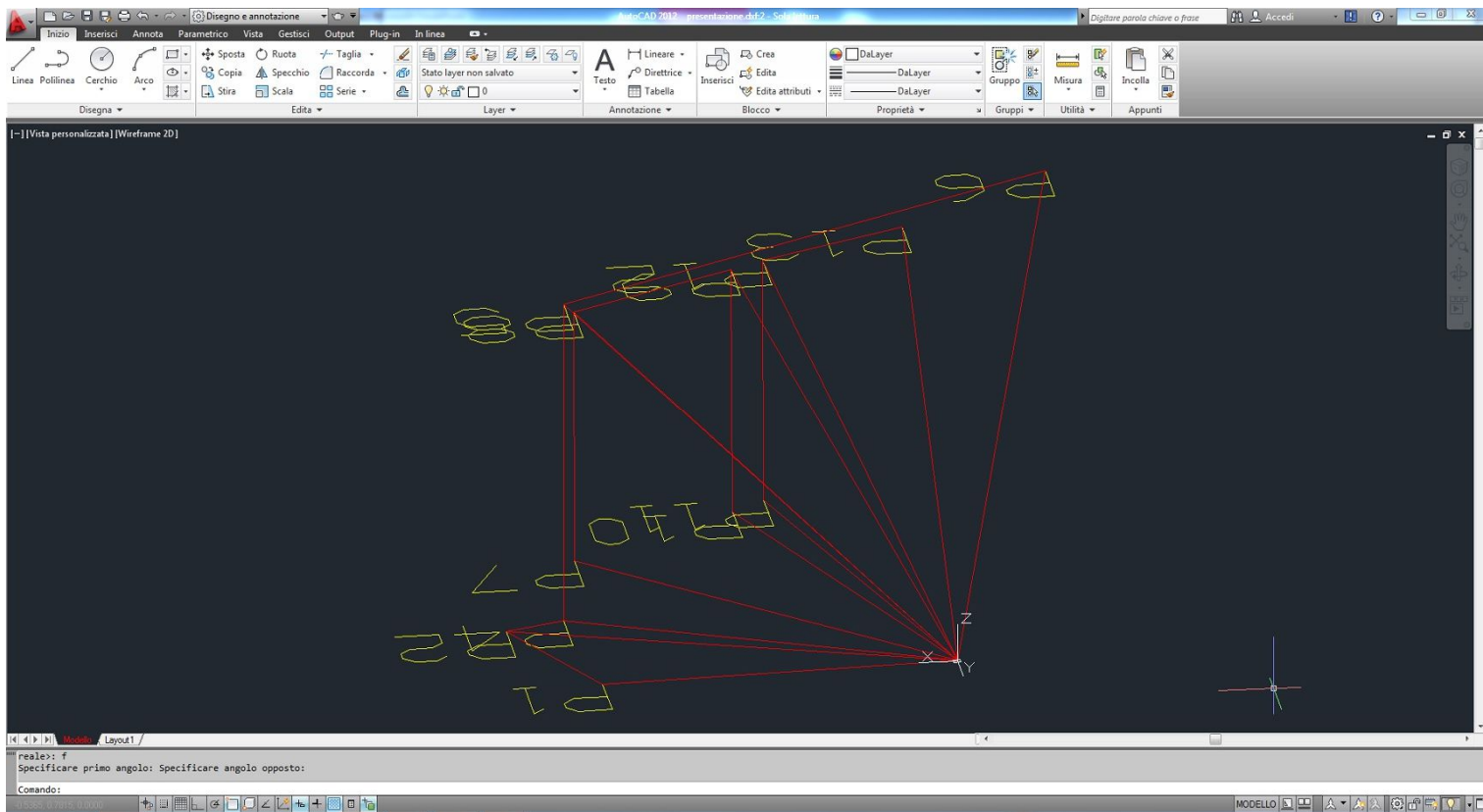

ArTeN

 HEXAGON

- when it has to be right 

# Android option Setup

These options can affect the correct operation of the Digiplan S910

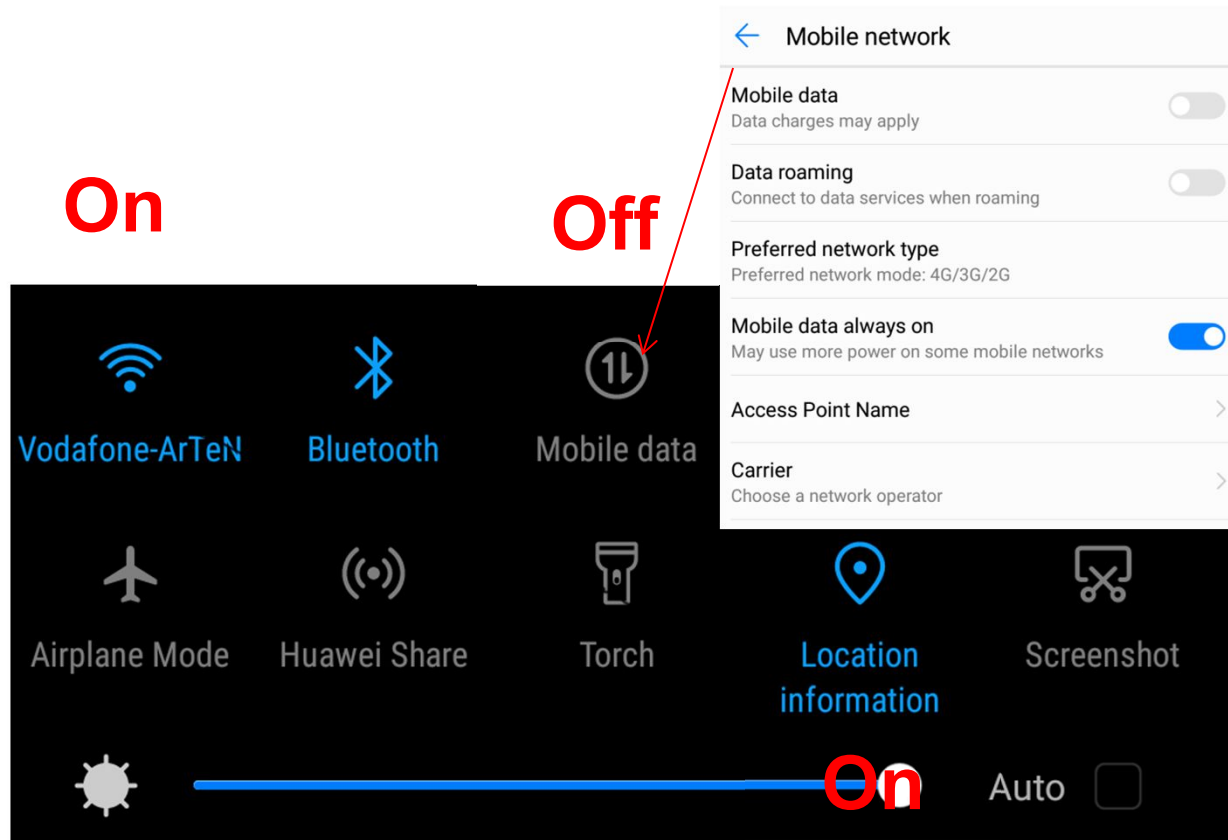

**GRAZIE PER L'ATTENZIONE**

**ArTeN**



- when it has to be right *Leica*  
Geosystems